



# T&S BRASS AND BRONZE WORKS, INC.

2 Saddleback Cove / P.O. Box 1088  
Travelers Rest, SC 29690

Model No.

**CEF-EU1DG-VF05**

Item No.

Travelers Rest, SC: 800-476-4103 • Simi Valley, CA: 800-423-0150 • Fax: 864-834-3518 • www.tsbrass.com

This Space for Architect/Engineer Approval

Job Name \_\_\_\_\_ Date \_\_\_\_\_

Model Specified \_\_\_\_\_ Quantity \_\_\_\_\_

Customer/Wholesaler \_\_\_\_\_

Contractor \_\_\_\_\_

Architect/Engineer \_\_\_\_\_

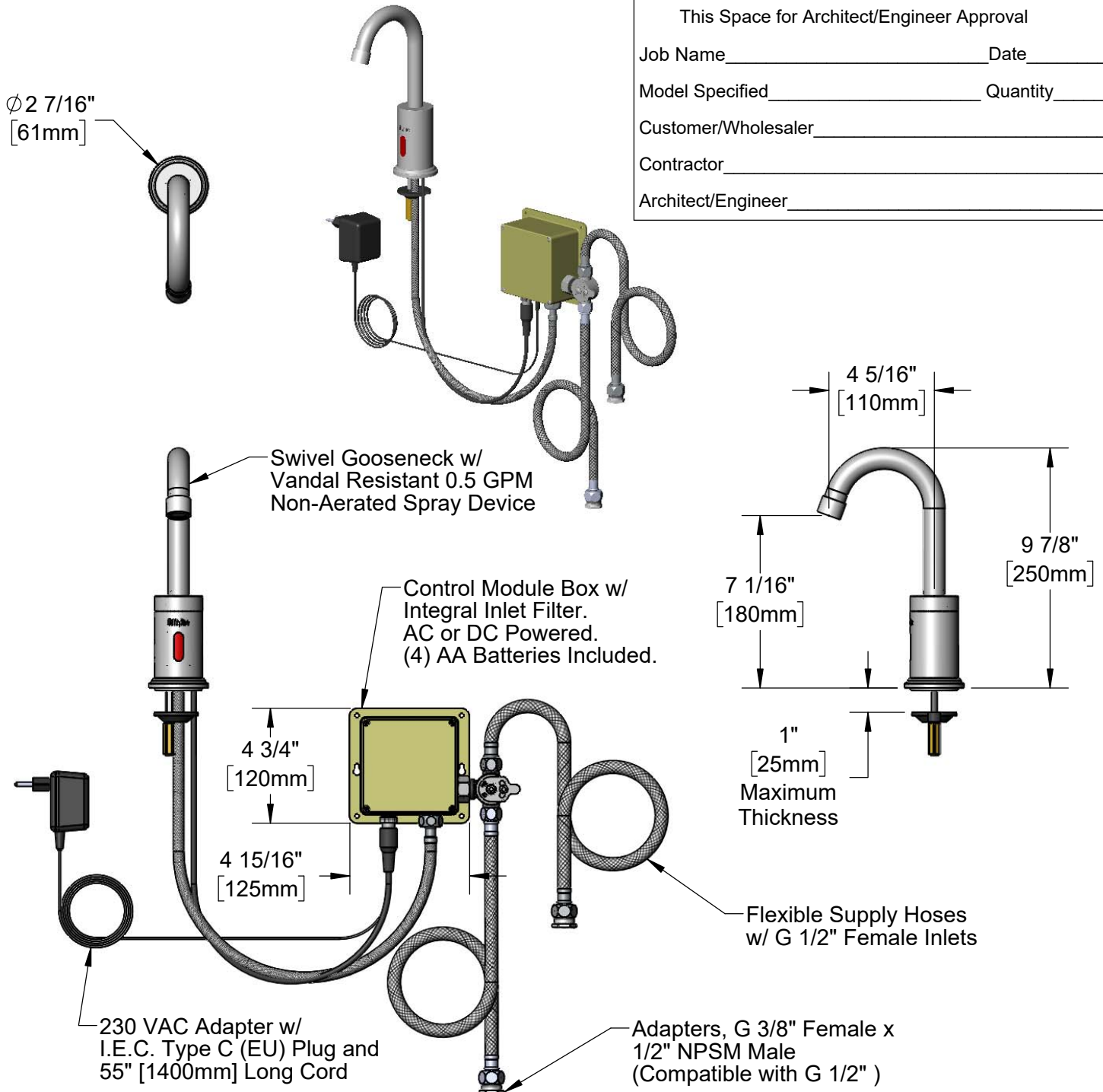

Rough-In Requirement:  
Ø 1 1/4" [32mm] Mounting Hole

## Product Specifications:

Single Hole Deck Mount Sensor Faucet w/ Swivel Gooseneck, VR 0.5 GPM Non-Aerated Spray Device, Control Module, AC Adapter w/ EU Plug, Mechanical Mixing Valve and Flexible Supply Hoses w/ G 3/8" Female Inlet Adapters

## Product Compliance:

Drawn: DMH    Checked: JRM    Approved: JHB    Date: 05/08/20    Scale: 1:6    Sheet: 1 of 2



**T&S BRASS AND BRONZE WORKS, INC.**  
2 Saddleback Cove / P.O. Box 1088  
Travelers Rest, SC 29690

Model No.  
**CEF-EU1DG-VF05**  
Item No.

Travelers Rest, SC: 800-476-4103 • Simi Valley, CA: 800-423-0150 • Fax: 864-834-3518 • www.tsbrass.com

ITEM NO.	SALES NO.	DESCRIPTION
1	EU-0199-M22-V05	VR 0.5 GPM Spray Device, M22 x 1 Female
2	020377-45	Sensor Cable
3	019920-45	Control Module
4	019921-45	Mechanical Temperature Mixing Valve
5	019922-45	Supply Hose, G 3/8" x G 1/2" Connections
6	020498-25	Hex Bushing, G 3/8" Female x 1/2 NPSM Male w/ Sealing Washer
7	019926-45	Flexible Connector Hose
8	019924-45EU	Plug-in AC Adapter w/ EU Plug

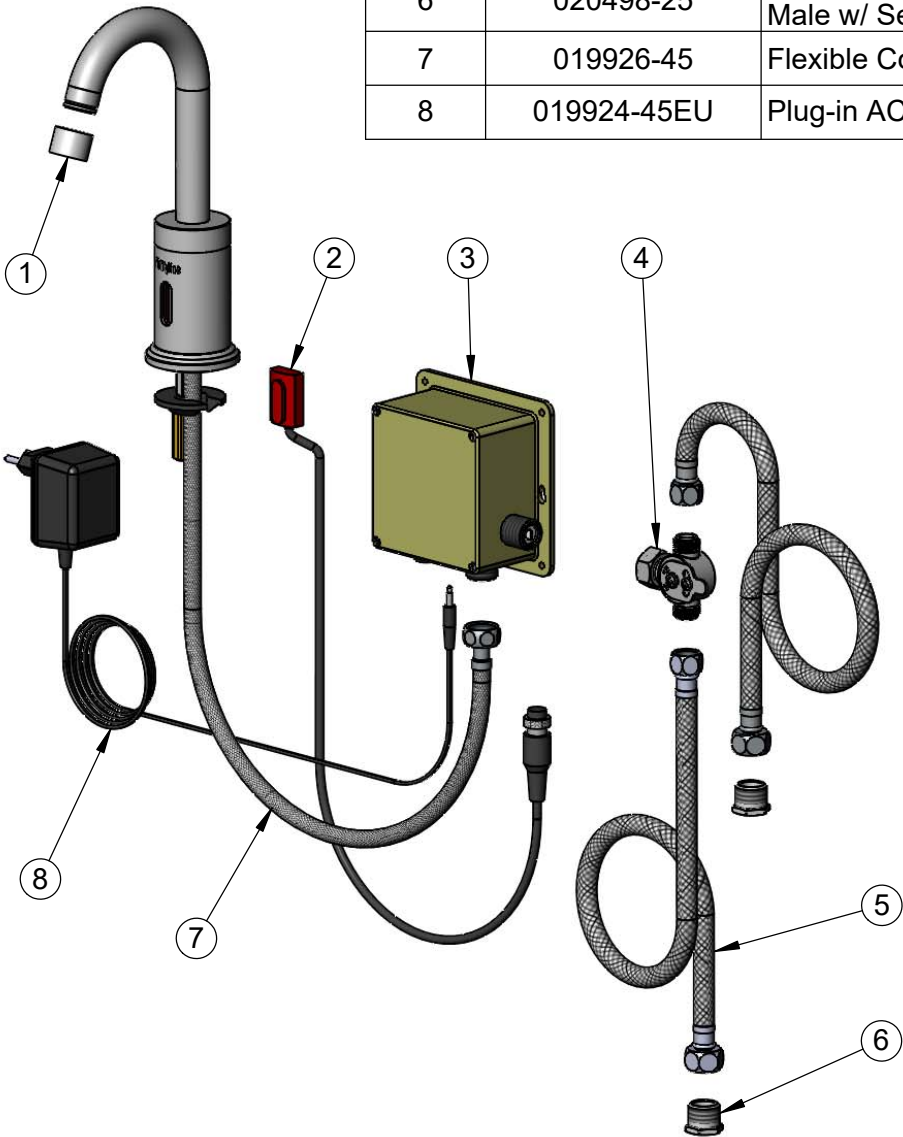

Product Specifications:  
Single Hole Deck Mount Sensor Faucet w/ Swivel Gooseneck, VR 0.5 GPM Non-Aerated Spray Device, Control Module, AC Adapter w/ EU Plug, Mechanical Mixing Valve and Flexible Supply Hoses w/ G 3/8" Female Inlet Adapters

Product Compliance: