

# EXPLOSIONSZEICHNUNG

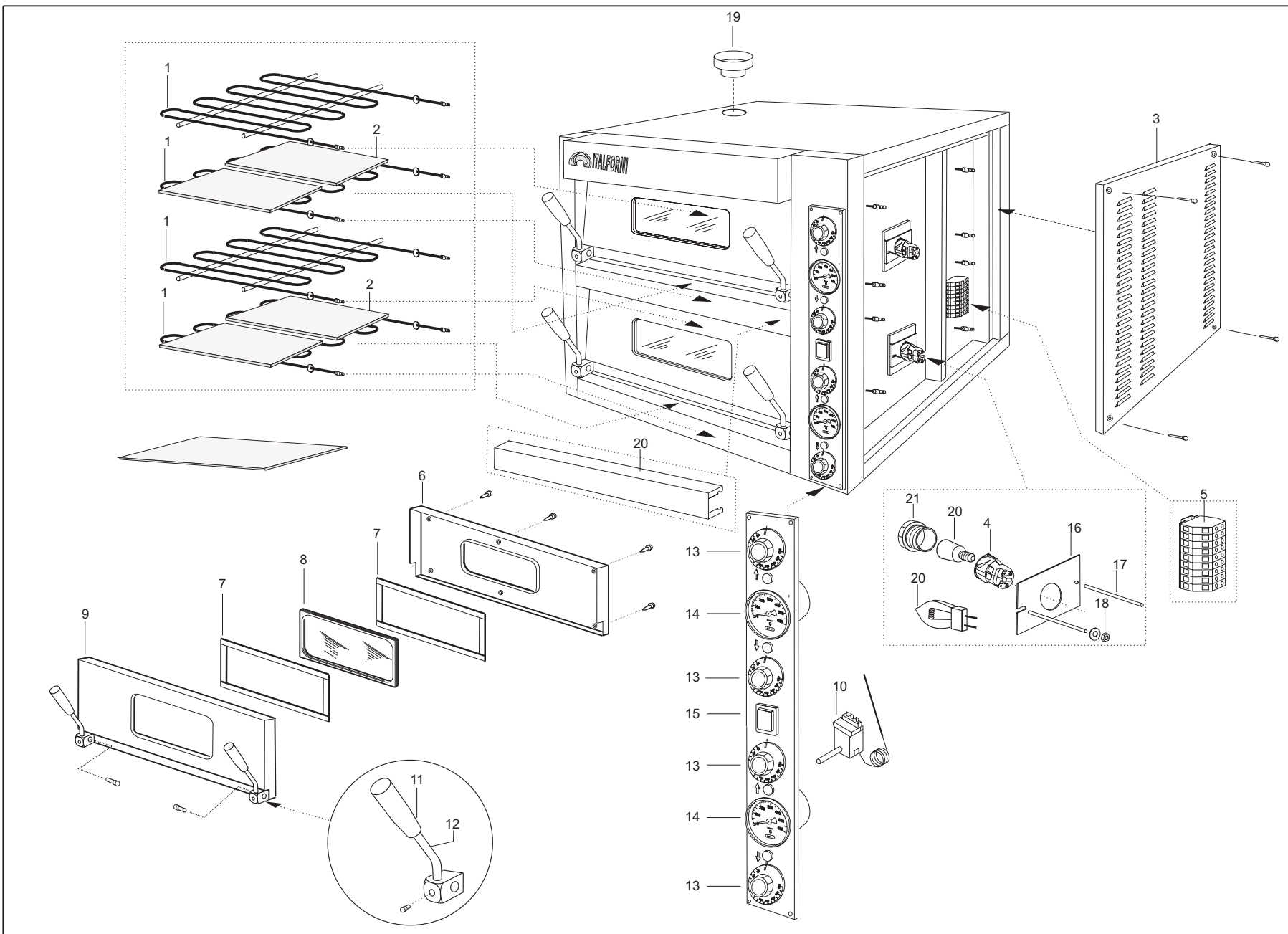

KBS Gastrotechnik GmbH – Schoßbergstraße 26 – 65201 Wiesbaden



Rif	Code	Qnt
1	59100001	4
2	52300002	4
3	000000	1
4	86131007	2
5	86208001	1
5-A	86208002	1
5-B	86211001	1
5-C	86213001	1
6	53000004	2
7	57700007	4
8	58300001	2
9	53000008	2
10	86301001	4
11	81229001	4
12	52100001	4
13	81229005	4
14	86501001	2
15	86125011	1
16	000000	2
17	000000	4
18	000000	4
19	57900001	1
20	86130003	2
21	86133004	2
22	86132001	1
23	86103005	1
24	00000000	1
25	00000000	1

ASSIEME - ENSAMBLE - ASSEMBLE - GESANTANSICHT - TK-2A (INOX)

**TK 2A INOX**

Ref.	Code	Description	
20	86130003	HALOGEN BULB 12V	
4	86131007	HALOGEN LAMP HOLDER	Complete 86131004
21	86133004	GLASS FOR HALOGEN BULB-SMALL	
23	86103005	TRANSFORMER	
1	59100001	HEATING ELEMENT	
6	53000004	ALUMINATE INTERIOR DOOR	
9	53000008	STAINLESS STEEL EXTERIOR DOOR	
8	58300001	TEMPERED GLASS 8MM	
12	52100001	ARM FOR DOOR OPENING	
11	81229001	HANDLE FOR DOOR OPENING	
19	57900001	CHIMNEY CONNECTION	
2	52300002	REFRACTORY PLATE 320X655X14	
10	86301001	AT THERMOSTAT	
13	81229005	RED KNOB FOR THERMOSTAT	
14	86501001	THERMOMETER	
15	86125011	GREEN SHINING DOUBLE SWITCH 12V (since 01/11/03)	cod.86125003 before 01/11/03
22	86132001	SHINING WARNING LIGHT	
5	86208001	BROWN TERMINAL	
5-A	86208002	BLUE TERMINAL	
5-B	86211001	TERMINAL COVER	
5-C	86213001	TERMINALS CLAMPING	
7	57700007	KIT SEALS FOR GLASS DOOR	